

Special top plate conveyor chain

For cross-linking of systems

The main advantage compared to previous solutions is that the top plates are no component parts of the inner and outer links of the actual chain.

The plates are attached in the hollow pin as a separate assembly part. This specific DBGM protected construction characteristic (DBGM 295 05 477.8) allows for the top plates to be replaced even with a tensioned chain, i.e. the chain does not have to be separated.

Due to an additional short pin attached to the top plate the plate is twist-secured. The floating assembly of the top plate can compensate minor height differences of the slideways.

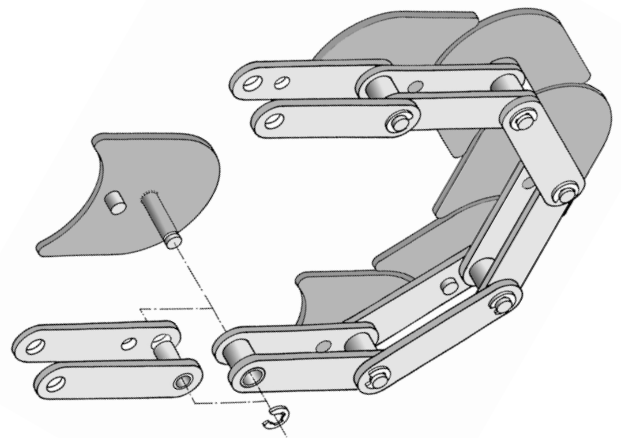

- Apart from that we have succeeded in considerably reducing the distance between the plates compared to previous solutions.
- The sickle-shaped conveyor plates allow unrestricted motion through narrow bends and curves.
- Owing to the special construction of the WIPPERMANN special top plate conveyor chain an identical run of the top plate and the basic chain is guaranteed.
- In order to facilitate assembly and disassembly, the top plates were mounted with circlips.
- The WIPPERMANN special top plate conveyor chain with its especially narrow chain plate construction ensures a larger bearing area of the top plates on the guide profiles.

- The top plates are coated and therefore have a high wear protection.
- The WIPPERMANN special top plate conveyor chain is fully compatible with other systems.

Top plate conveyor chains suitable for following curved paths are installed in particular for long conveyor distances and high loads.

Primarily, they are required by the beverage and food industry and by subcontractors to the automotive industry.

Sprockets on request.

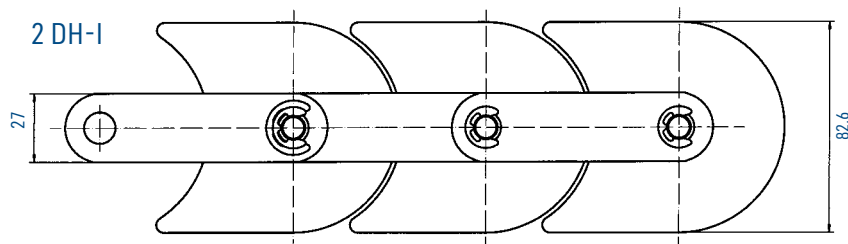

Chain	Weight	Minimum tensile strength
No.	kg/m	kN
2 DH-I	3,4	55,0

